

Kepler CCD Camera

DC23084

The Kepler DC23084 offers an outstanding combination of high quantum efficiency, large dynamic range, deep full well capacity, excellent cooling and large imaging area.

Technical Data

Sensor Type	Back Illuminated CCD
Sensor	e2v CCD230-84-1-145 (MB)
Shutter Type	
Active Pixels	4096 x 4096
Pixel Size (microns)	15 x 15 μm
Imaging Area (Diagonal)	61.4 X 61.4 mm (86.8 mm)
Full Well Capacity (e-)	150000 electrons
Typical Readout Noise	15 e-
Dynamic Range	79.7 dB
Frame Rate	
Cooling Method¹	Air or Liquid
Max. Cooling (Air)	60°C below ambient
Temperature Stability	0.1°C
Dark Current (typical)	0.1 eps at -30C
Interface	USB 3.0
Data Bit Depth	16
Optional Shutter	optional 90 or 120 mm
Optional Mounts	Medium Format Recommended (6x7)
Subarray Readout	Standard
External Trigger In/Out	Standard
SDK / Software	Kepler / FLI Pilot
Weight	8.2 lbs (3.7 kg)



Shown with optional 90mm shutter

Absolute Quantum Efficiency

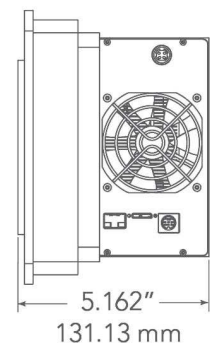
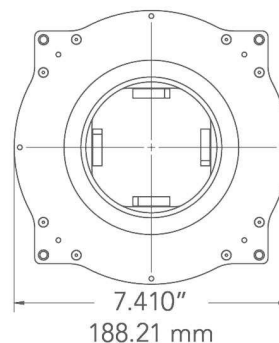
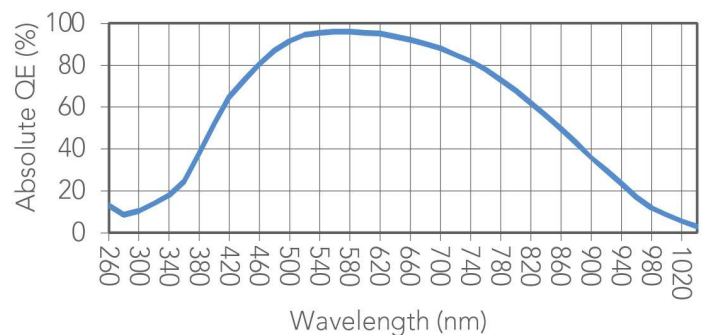

See www.flicamera.com for alternate configurations



MADE IN USA

Finger Lakes Instrumentation
www.flicamera.com
USA 585-624-3760